



**COLDWELL  
BANKER  
COMMERCIAL**

**PREMIER PROPERTIES**

**FOR SALE**

## **NEWER WAREHOUSE BUILDING PLUS 1/2 ACRE OF LAND!**

5950 US Highway 1 South  
Saint Augustine, FL 32086

AVAILABLE SPACE  
1,800SF Building and 1/2 Acre Land

For Sale...\$799,000.00

### **FEATURES**

- GREAT OPEN WORK BAY FOR ALL PROJECTS REQUIRING 110v AND 220v
- COMMERCIAL GENERAL ALLOWS FOR LOTS OF DIFFERENT BUSINESS OPPORTUNITIES

### **AREA**

DIRECTLY ON BUSY US HIGHWAY 1 SOUTH IN ST AUGUSTINE



### **OFFICE**

Eric Maimo  
904 537 6443  
eric.maimo@coldwellbanker.com

Michael Gehring  
407 951 4849  
cmichaelgehring@gmail.com

©2020 Coldwell Banker. All Rights Reserved. Coldwell Banker and the Coldwell Banker Commercial logos are trademarks of Coldwell Banker Real Estate LLC. The Coldwell Banker® System is comprised of company owned offices which are owned by a subsidiary of Realogy Brokerage Group LLC and franchised offices which are independently owned and operated. The Coldwell Banker System fully supports the principles of the Equal Opportunity Act.

**COLDWELL BANKER COMMERCIAL  
PREMIER PROPERTIES**  
1750 Tree Blvd., Suite 7, Saint Augustine, FL 32084  
904.827.1717

CBCWORLDWIDE.COM



LEASE

# NEWER WAREHOUSE BUILDING PLUS 1/2 ACRE OF LAND!

5950 US Highway 1 South, Saint Augustine, FL 32086



## INVESTMENT OFFERING SUMMARY

Available SF: 1,800SF BUILDING  
AND 1/2 ACRE LAND

Lot Size: 0.85 Acres

Year Built: 2018

Building Size: 1,800 SF

Zoning: CG

Market: St Augustine

CBCWORLDWIDE.COM

Eric Maimo  
904 537 6443  
eric.maimo@coldwellbanker.com

Michael Gehring  
407 951 4849  
cmichaelgehring@gmail.com

## PROPERTY OVERVIEW

This is AN INVESTMENT OPPORTUNITY that is FULLY OCCUPIED with LEASES IN PLACE through the END OF 2022! STEEL BUILDING DIRECTLY ON BUSY US1 SOUTH IN ST AUGUSTINE. EASY ACCESS WITH PLENTY OF OVERFLOW PARKING AS THERE IS A CLEARED 1/2 ACRE BEHIND BUILDING FOR PARKING AND TURN AROUND FOR BIG DELIVERY TRUCKS.

## PROPERTY HIGHLIGHTS



**COLDWELL  
BANKER  
COMMERCIAL**

PREMIER PROPERTIES





# NEWER WAREHOUSE BUILDING PLUS 1/2 ACRE OF LAND!

5950 US Highway 1 South, Saint Augustine, FL 32086

LEASE



CBCWORLDWIDE.COM

Eric Maimo  
904 537 6443  
eric.maimo@coldwellbanker.com

Michael Gehring  
407 951 4849  
cmichaelgehring@gmail.com

 **COLDWELL  
BANKER  
COMMERCIAL**  
PREMIER PROPERTIES





# NEWER WAREHOUSE BUILDING PLUS 1/2 ACRE OF LAND!

5950 US Highway 1 South, Saint Augustine, FL 32086

LEASE



CBCWORLDWIDE.COM

Eric Maimo  
904 537 6443  
eric.maimo@coldwellbanker.com

Michael Gehring  
407 951 4849  
cmichaelgehring@gmail.com

 **COLDWELL  
BANKER  
COMMERCIAL**  
PREMIER PROPERTIES





**NEWER WAREHOUSE BUILDING PLUS 1/2 ACRE OF LAND!**

5950 US Highway 1 South, Saint Augustine, FL 32086

LEASE

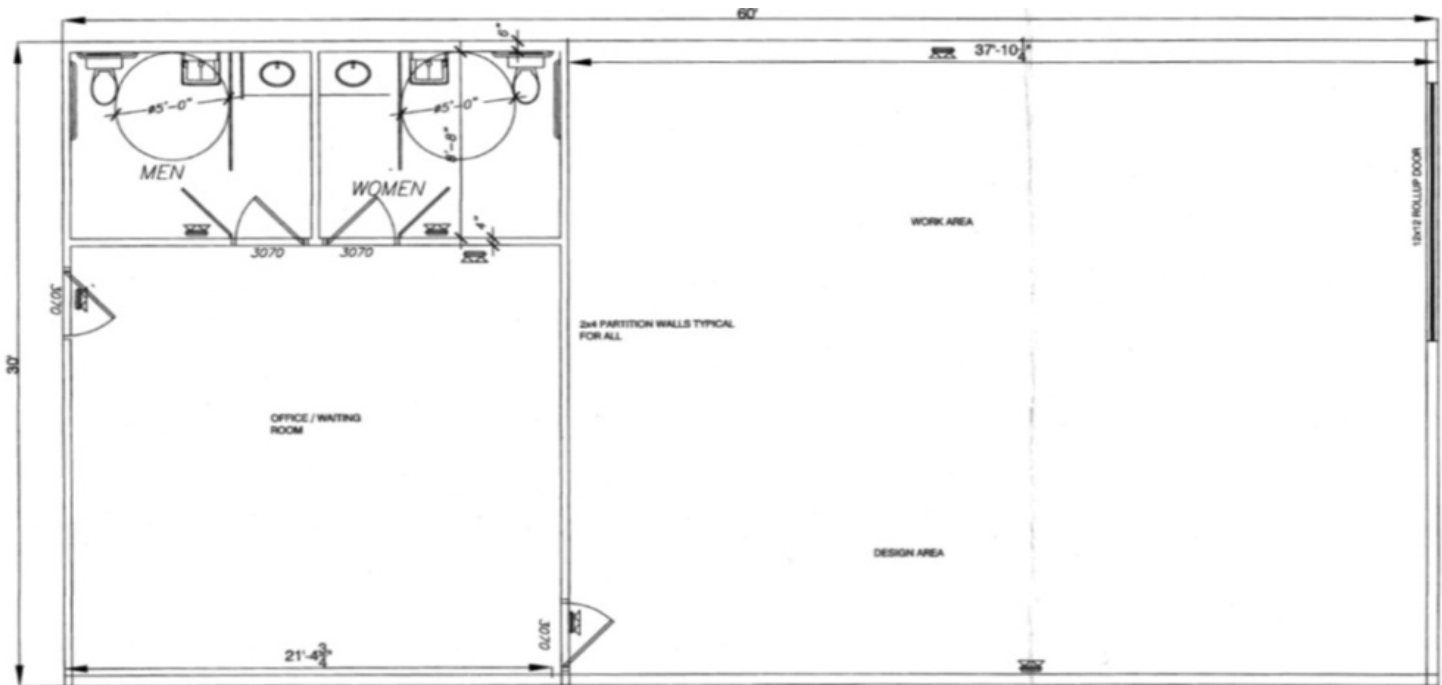

**FLOOR PLAN**

CBCWORLDWIDE.COM

Eric Maimo  
904 537 6443  
eric.maimo@coldwellbanker.com

Michael Gehring  
407 951 4849  
cmichaelgehring@gmail.com

**COLDWELL  
BANKER  
COMMERCIAL**  
PREMIER PROPERTIES



# NEWER WAREHOUSE BUILDING PLUS 1/2 ACRE OF LAND!

5950 US Highway 1 South, Saint Augustine, FL 32086

LEASE

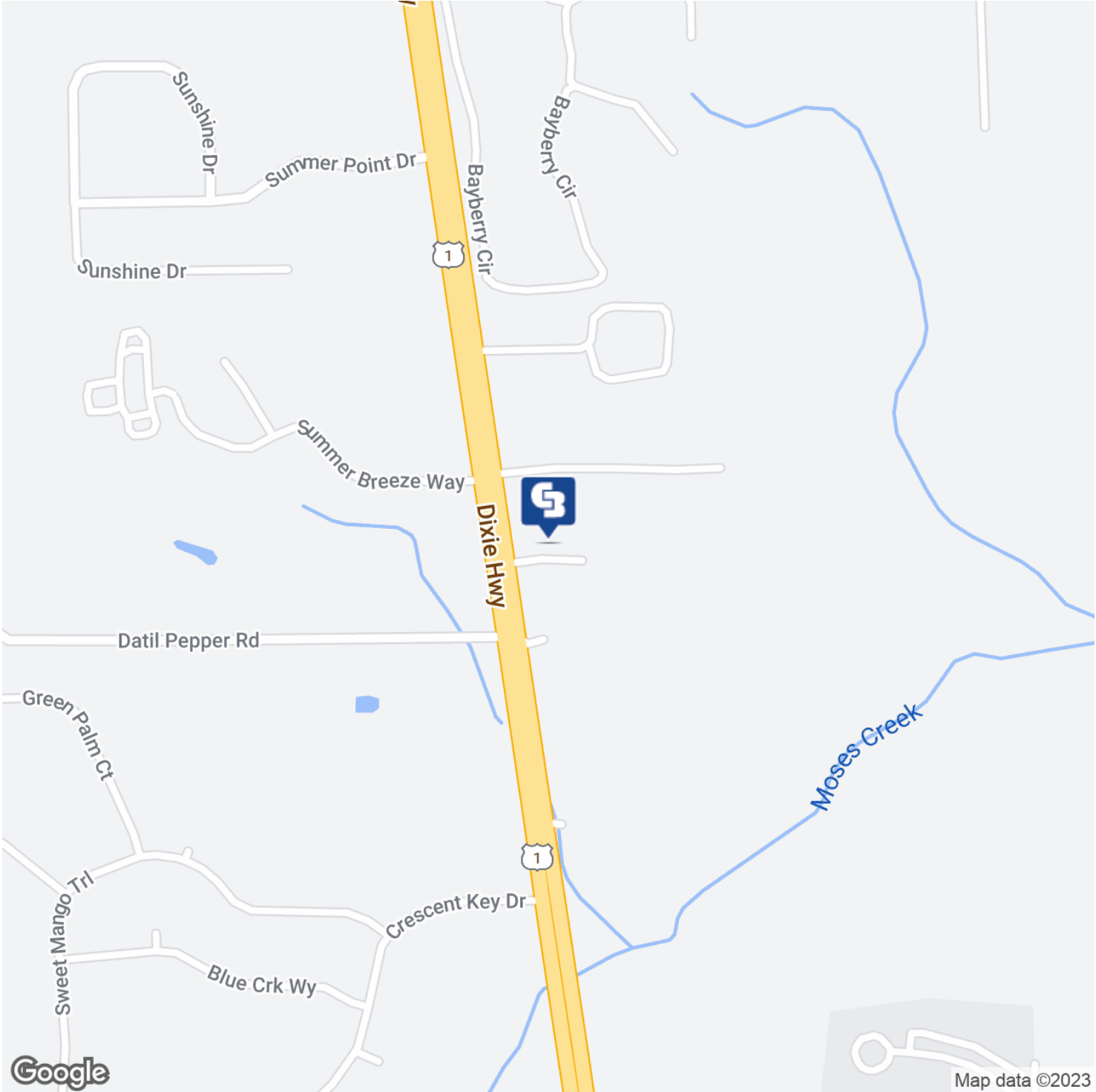

CBCWORLDWIDE.COM

Eric Maimo  
904 537 6443  
eric.maimo@coldwellbanker.com

Michael Gehring  
407 951 4849  
cmichaelgehring@gmail.com

 **COLDWELL  
BANKER  
COMMERCIAL**  
PREMIER PROPERTIES



# NEWER WAREHOUSE BUILDING PLUS 1/2 ACRE OF LAND!

5950 US Highway 1 South, Saint Augustine, FL 32086

LEASE

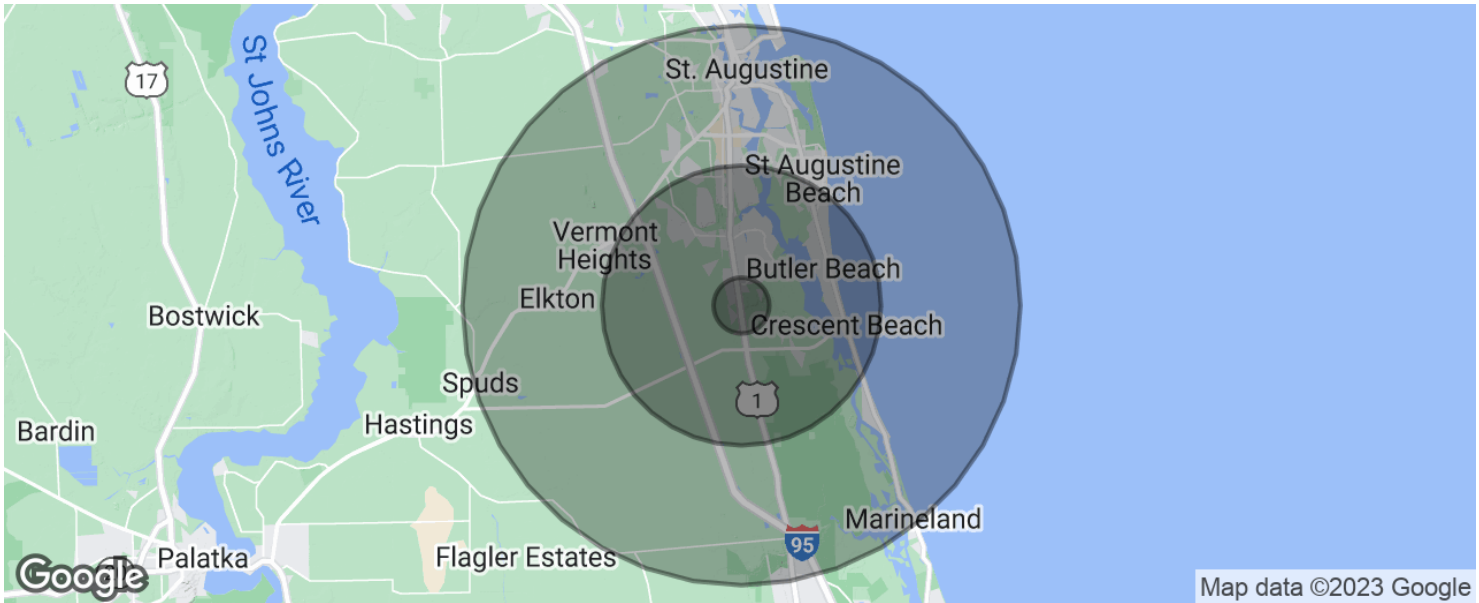

POPULATION	1 MILE	5 MILES	10 MILES
Total population	1,202	31,973	78,180
Median age	45.3	48.0	44.9
Median age (Male)	45.4	46.3	43.6
Median age (Female)	44.2	49.5	45.8
HOUSEHOLDS & INCOME	1 MILE	5 MILES	10 MILES
Total households	455	13,778	32,788
# of persons per HH	2.6	2.3	2.4
Average HH income	\$68,195	\$68,766	\$63,742
Average house value		\$310,755	\$344,411

\* Demographic data derived from 2020 ACS - US Census

CBCWORLDWIDE.COM

Eric Maimo  
904 537 6443  
eric.maimo@coldwellbanker.com

Michael Gehring  
407 951 4849  
cmichaelgehring@gmail.com

 **COLDWELL  
BANKER  
COMMERCIAL**  
PREMIER PROPERTIES

Monthly Income	SF	Month Gross	Annual % Inc.	Lease Expiration	Options
Tenant					
Oceanview Landscape MGMT		\$ 3,403.37	3%	1-Nov-22	One 3yr
Total Monthly Income		\$ 3,403.37			
<u>Yearly Expenses</u>			<u>Summary</u>		
Insurance		\$ 551.05		Yearly Income	\$ 40,840.44
RE Taxes		\$ 3,022.65		Yearly Expenses	\$ 3,573.70
			<u>N.O.I.</u>		\$ 37,266.74
			<u>Asking Price</u>		\$ 699,000.00
Total Expenses		\$ 3,573.70	<u>Cap Rate</u>		5.33%